

# CME 05 - 06

## 5/6 DIGIT METER RESETTABLE

- **5-digit h = 5 mm display**  
white digits on black background (whole)  
white digit on red background (decimal)
- **resetting wheel**
- **materials**  
PA 66 Nylon body  
ABS casing  
acetalic resin components  
command shaft in AISI 303  
self-lubricating internal kinematic motion devices
- **max speed**  
100.0 meters / min.



gr. 50

mm 85 x 55 x 35

### TYPICAL APPLICATIONS

Cloth - tape - rope - extruded materials - etc... measurements

COD.	MOD.	COD.	MOD.	GEAR RATIO	SHAFT OUTPUT	ROTAT.
FC0420/003	<b>CME 05 D</b>	FC0420/005	<b>CME 06 D</b>	10 revol. / 1.0 meters	right	bidirectional
FC0420/004	<b>CME 05 S</b>	FC0420/006	<b>CME 06 S</b>	10 revol. / 1.0 meters	left	bidirectional

⊗ 5 digit model: **solding out**      ⊗ 6 digit model: **up to date production**

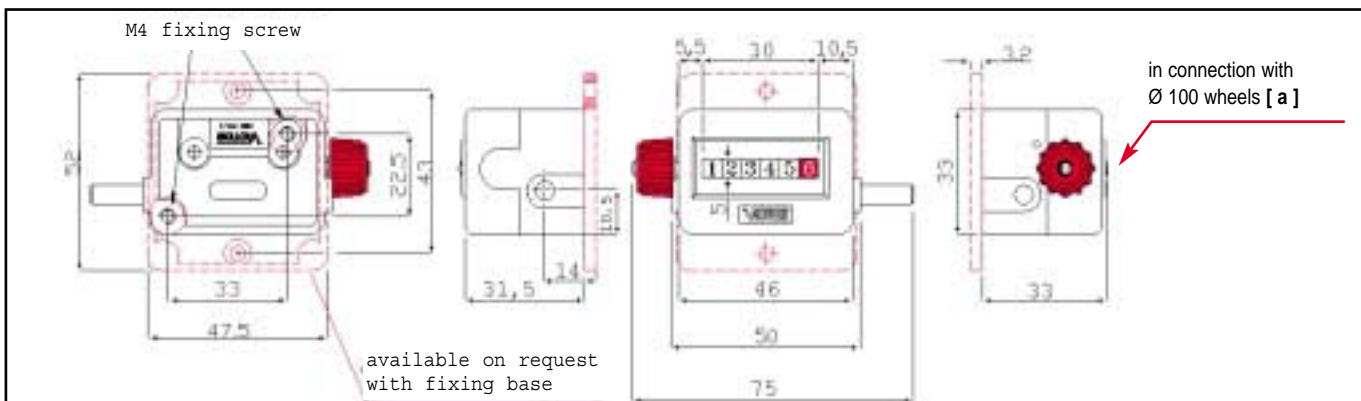

COD.	RIF.	DESCRIPTION	Ø mm.	STRIP WIDTH mm
FV0010/081	[ a ]	Knurled aluminium wheel Development = 100 mm	31,83	10
FV0010/080	[ a ]	Knurled mopen wheel Development = 100 mm	31,83	7

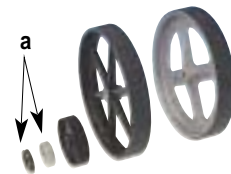

CODE INDICATION		
model	shaft output	gear ratio
<b>example of order</b> CME 05	<b>S</b>	<b>10/1</b>
<b>description</b>	<i>left</i>	<i>10 rounds per meter with red decimal</i>

METERS



# 5-DIGIT METER RESETTABLE

# CM 05



- **5-digit h = 6 mm display**  
white digits on black background (whole)  
white digit on red background (decimal)

- **quick resetting lever**

- **materials**  
die-cast zamak body  
ABS casing  
metal internal kinematic motion devices

- **max speed**  
500.0 meters / min.

gr. 357

mm 125 x 65 x 35

### TYPICAL APPLICATIONS

Cloth - tape - rope - extruded materials - etc... measurements

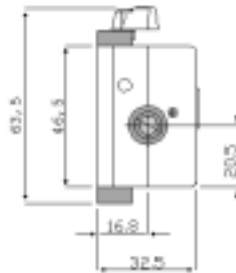
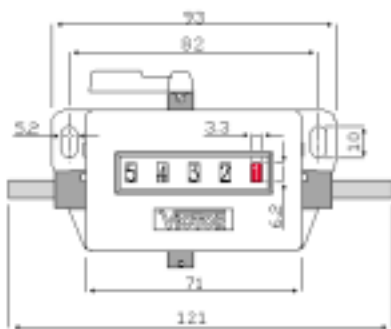

COD.	MOD.	GEAR RATIO	SHAFT OUTPUT	ROTAT.
FC0010/101	<b>CM 05 D</b>	10 revol. /1.0 meters (+)	passing	right
FC0010/102	<b>CM 05 S</b>	10 revol. /1.0 meters (+)	passing	left
FC0010/103	<b>CM 05 D</b>	5 revol. / 1.0 meters (++)	passing	right
FC0010/104	<b>CM 05 S</b>	5 revol. / 1.0 meters (++)	passing	left

**Note :**  
 • (+) To be fitted with 100 mm development [ a ] wheels  
 • (++) To be fitted with 200 mm development [ b ] wheels

COD.	RIF.	DESCRIPTION	Ø mm.	STRIP WIDTH mm
FV0010/081	[ a ]	Knurled aluminium wheel Development = 100 mm	31.83	10
FV0010/080	[ a ]	Knurled moplen wheel Development = 100 mm	31.83	10
FV0010/087	[ b ]	Rubberized moplen wheel Development = 200 mm	63.66	17

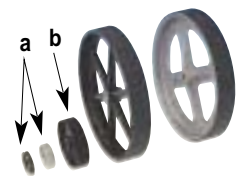

CODE INDICATION		
model	shaft rotation	gear ratio
<b>example of order</b> CM 05	<b>S</b>	<b>5/1</b>
<b>description</b>	left	5 rounds per meter with red decimal

# KME 06

## 6-DIGIT METER HEAVY DUTY RESETTABLE

- **6-digit h = 8 mm display**  
white digits on black background (whole)  
white digit on red background (decimal)  
or all white on black background  
(without decimal)
- **quick resetting lever**
- **materials**  
die-cast zamak body  
ABS casing  
command shaft in AISI 303  
self-lubricating synthetic material kinematic  
motion devices
- **max speed**  
500.0 meters / min.

gr. 790

mm 170 x 70 x 55



### TYPICAL APPLICATIONS

Clothe - tape - rope - extruded materials -  
etc... measurements

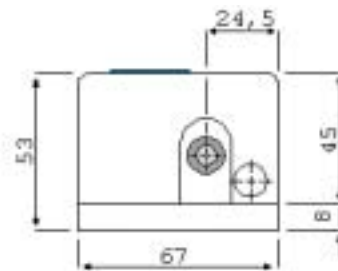
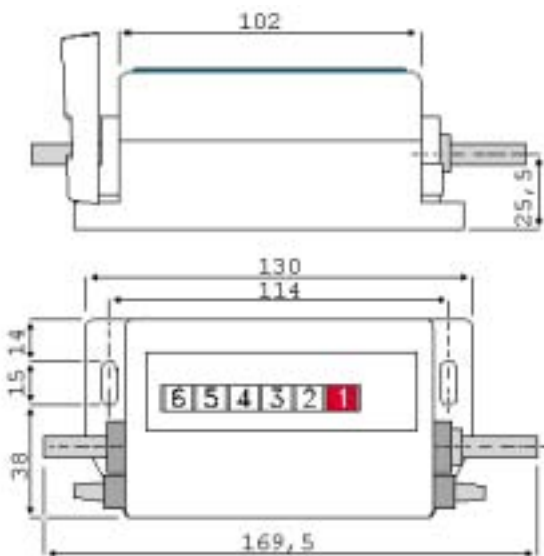

COD.	MOD.	RATIO	SHAFT OUTPUT	ROTAT.
FC0875/003	<b>KME 06 D</b>	2 revol. / 1 meters	passing	right
FC0875/004	<b>KME 06 S</b>	2 revol. / 1 meters	passing	left
FC0875/005	<b>KME 06 D</b>	1 revol. / 0.5 meters	passing	right
FC0875/006	<b>KME 06 S</b>	1 revol. / 0.5 meters	passing	left

**Note :**

- 

COD.	RIF.	DESCRIPTION	Ø mm.	STRIP WIDTH mm
FV0085/071	[ c ]	Rubberized moplen wheel Development = 500 mm	159.15	23
FV0085/073	[ c ]	Aluminium wheel+rubber strip Development = 500 mm	159.15	23

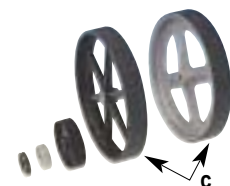

	CODE INDICATION		
	model	shaft rotation	gear ratio
<b>example of order</b>	<b>KME 06</b>	<b>S</b>	<b>1/5</b>
<b>description</b>		<i>left</i>	<i>5 rounds per meter with red decimal</i>

METERS



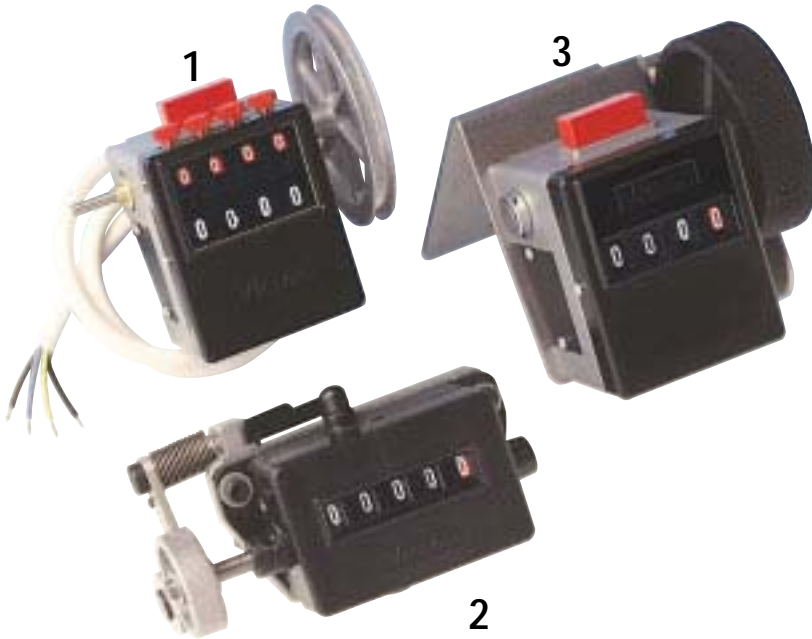

1 - PREDETERMINING AND RESETTABLE REVOLUTION DOWNCOUNTING METER FOR THREADS

2 - METERS FOR TAPES

3 - METER FOR WIRES

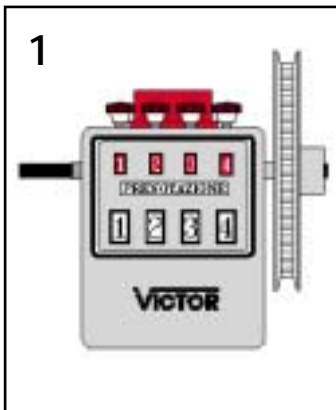

## TEXTILE 04

- **4-digit h = 6 mm display**  
4 white digits on black background (counting)  
4 white digits on red background (programming)
- **quick press resetting key for preset value**
- **materials**  
Die-cast zamak body  
ABS casing  
Metal internal kinematic motion devices
- **fixed displayed preset value**
- **contact range** 1 AMP, 24 V CC;
- **command shaft**  
in AVP steel mounted on very smooth ball bearings (torque  $5 \pm 10$  gcm)



gr. 420



mm 115 x 95 x 50

### TYPICAL APPLICATIONS

Speed indicator version: tool machines, winding machines, automatic machines, etc.

Meter version: particularly suited to the measurement of weaving thread (silk thread, wool, etc...) as well as tape, rope, clothe, etc....

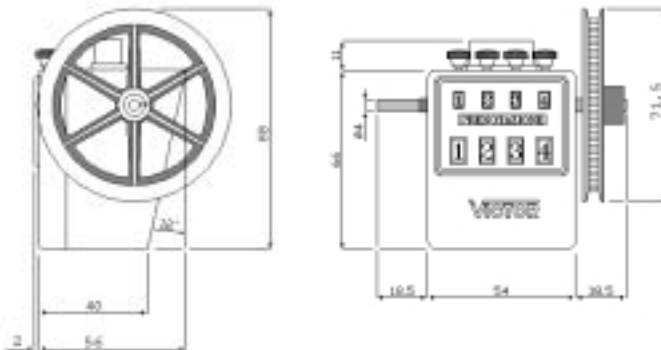

### ACCESSOIRES:

- Knurled sheave, development 200 mm
- Knurled rubberized pulley, development 200 mm

	RATIO	MEASUREMENT RANGE	SPEED COMMAND SHAFT
1/1	1 round=1 digit	speed indicator	5,000
1/2	1 round=2 dm	m 999.9	2,500
5/1	5 rounds=1 m	m 9,999	15,000
50/1	50 rounds=1 dam	m 9,999(x10)	15,000
500/1	500 rounds=1 hm	m 9,999(x100)	15,000

COD.	MOD.	
FC0475/001	TEXTILE 04 1/1	SHAFT OUTPUT
FC0475/002	TEXTILE 04 1/2	right
FC0475/003	TEXTILE 04 5/1	
FC0475/004	TEXTILE 04 50/1	ROTATION
FC0475/005	TEXTILE 04 500/1	right

# METERS

2

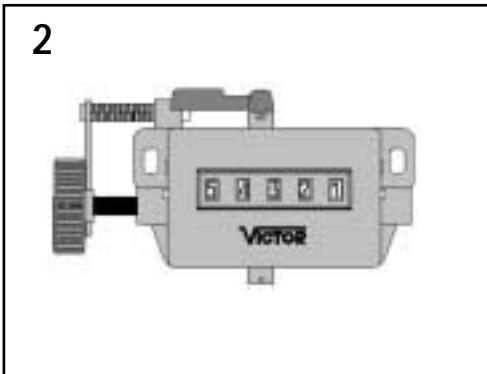

## TAPE METER

- **5-digit h = 6 mm display**  
4 white digits on black background  
+ 1 white digit on red background
- **quick resetting lever**
- **materials**  
die-cast zamak body  
ABS casing  
metal internal kinematic motion devices

- Die-cast counter plate for fixing on Ø 16 mm rod with a device equipped with a contrasting wheel to ensure better adherence

gr. 560

(x 2 blows) mm 180 x 65 x 65

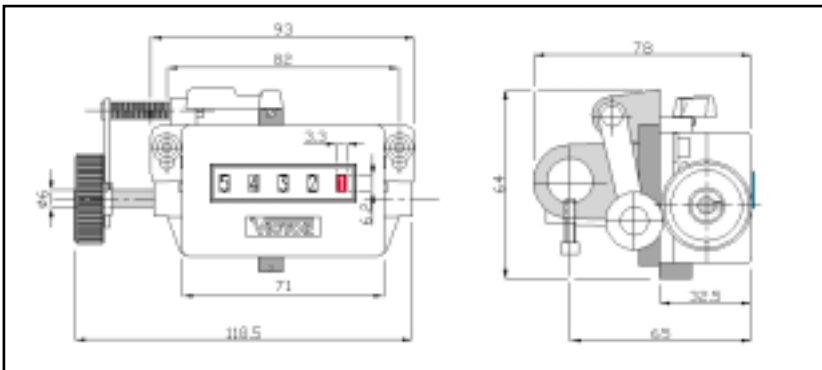

### TYPICAL APPLICATIONS

Tape - clothe - laminated in general measurement

COD.	MOD.	SHAFT OUTPUT	ROTAT. ↻
FC0010/004	TAPE METER	left	right
FC0010/005	TAPE METER	left	left

3

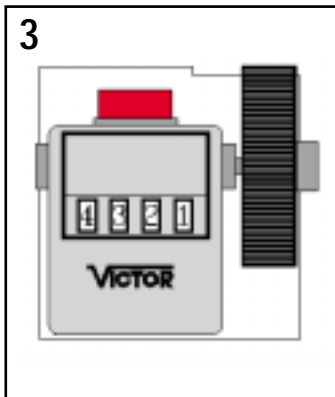

## WIRE METER

- **4-digit h = 6 mm display**  
3 white digits on black background  
+ 1 white digit on red background  
Maximum capacity m 999.9
- **quick resetting key**
- **materials**  
Die-cast zamak body  
ABS casing
- Metal internal kinematic motion devices

- 200 mm mopen + rubber wheel
- Stainless steel plate fixing support
- **Useful section for wires or ropes with a diameter comprised between 2.5 and 10 mm**

gr. 590

(x4 blows) mm 200 x 170 x 150

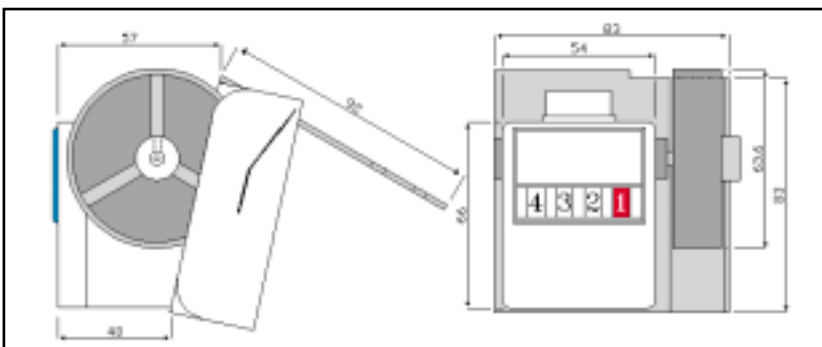

COD.	MOD.	SHAFT OUTPUT	ROTATION ↻
FC0475/006	WIRE METER	right	right

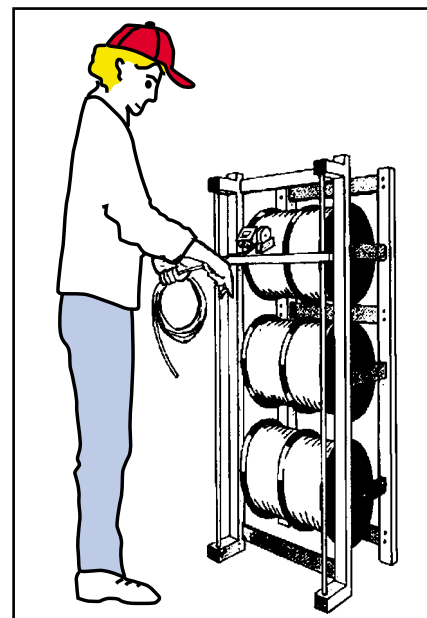

METERS

